



AZIMUTH STERN DRIVE TUG 3212

“MARS”

GENERAL

Yard number	512531
Delivery date	February 2017
Basic functions	Push-pull, escorting, towing and fire-fighting operations
Classification	I * HULL • MACH Escort Tug Unrestricted Navigation AUT UMS IWS Fire Fighting Ship 1 (2400 m ³ /h)
Flag	The Netherlands
Owner	Sleepdienst B. Iskes & ZN B.V.

DIMENSIONS

Length overall	32.70 m
Beam overall	12.82 m
Depth at sides	5.35 m
Draught aft	5.53 m
Displacement	793 t

TANK CAPACITIES

Fuel oil	132.6 m ³
Fresh water	15.2 m ³
Sewage	5.2 m ³
Lubrication oil	8.2 m ³
Dirty oil	4.8 m ³
Sludge	2.5 m ³
Bilge water	6.8 m ³
Foam	10.4 m ³

PERFORMANCES

Bollard pull ahead	82.5 t
Bollard pull astern	76.1 t
Speed ahead	14.1 kn
Speed astern	14.0 kn

PROPULSION SYSTEM

Main engines	2x Caterpillar 3516C HD+ TA/D
Total Power	5050 bkW (6772 bhp) at 1800 rpm
Thrusters	2x Rolls Royce US 255 P30 FP Special
Propeller	2800 mm Fixed Pitch
Forced ventilation	20.000/40.000 m ³ /h

AUXILIARY EQUIPMENT

Generator sets	2x Caterpillar C6.6 TA, 230/400 V, 125 kVA, 50 Hz
Bilge pumps	2x Sterling AKHA 6101, each 34 m ³ /h
Fuel pumps	Sterling AKHA 5101 and AOHA 3101
Cooling system	Box cooling + anti-growth system
Fresh water pressure set	Sterling HBK 111 / AOHA 3101
Hydraulic system	Main engine driven pumps
Fifi set	Fire-fighting pump (FIFI 1 2400 m ³ /h) driven by independent fixed mounted diesel engine combined with foam mixer
Fifi monitor	2x 1200 m ³ /h water and 2x 300 m ³ /h foam

DECK LAY-OUT

Anchor	2x 495 kg Pool (High Holding Power)
Anchor/towing winch	Hydraulically driven double drum winch, two speed winch, pull 38 ton at 12 m/min at second layer, 200 ton brake
Capstan	5 ton at 15 m/min, electrically driven
Crane	Heila HLRM 20-3S + winch MW 22
Towing hook aft	Mampaey SWL 100 ton
Towing winch aft	Hydraulically driven single drum winch with spooling device and warping head, pull 38 ton at 12 m/min at second layer and 200 ton brake
Fendering	D-fender at sides, cylinder fender at transom corners, cylinder bow fender with waterspray

ACCOMMODATION

For 10 persons, insulated and finished with durable modern linings, acoustical Dampa ceiling in the wheelhouse, floating floors and air-conditioned. With 6 cabins, galley, mess/dayroom, switchboard room, dry store and sanitary facilities.

NAUTICAL AND COMMUNICATION EQUIPMENT

Searchlights	2x 450 W Xenon
Radar system	1x Furuno FAR-2117 with 19" screen and 4 ft scanner 1x Furuno FAR 2117 with 19" screen and 6.5 ft scanner
Compass	Magnetic Kotter
Satellite compass	Furuno SC-50
Autopilot	Robertson AP-70
GPS	Furuno GP-150
Echosounder	Furuno FE-800
VHF	2x Sailor Compact 6222
VHF hand-held	2x Jotron Tron TR-20
VHF	Motorola DM4401
UHF hand-held	2x Motorola DP4401 DP
Navtex	Furuno NX-700A
Speed log	Furuno DS-80
AIS	Furuno FA-150
Inmarsat	2 Furuno Felcom 18 (one with DSC)
SSB	Furuno FS-1575
EPIRB	Jotron Tron-40S
Sart	Jotron Tron Sart 20
GSM telephone booster	Rosenvelt RF EW 13-F

DAMEN

AZIMUTH STERN DRIVE TUG 3212

"MARS"

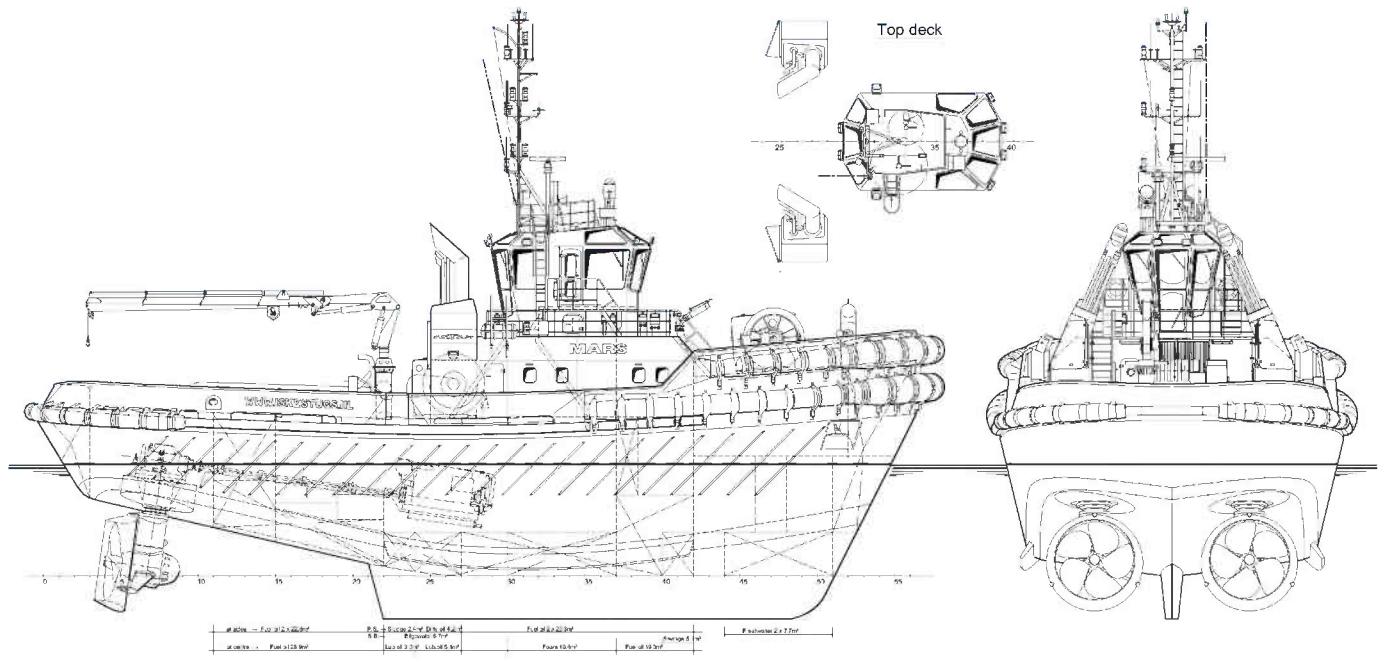

Main deck

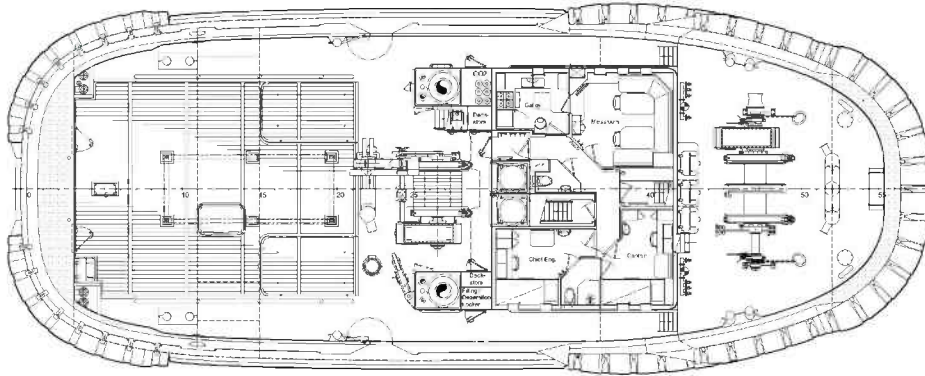

Bridge deck

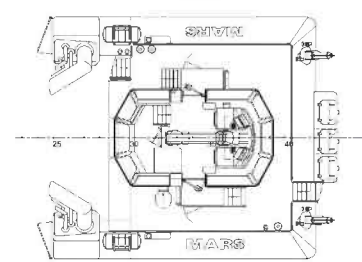

Below Main deck

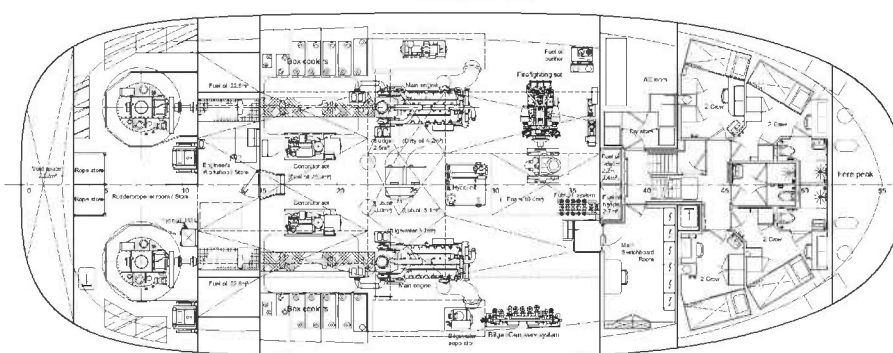

Lower deck

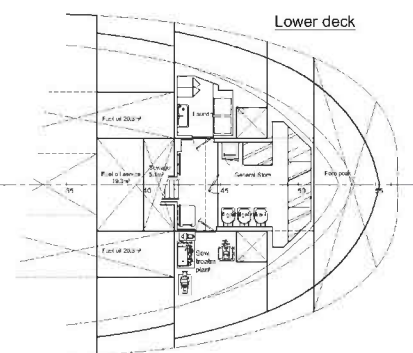

DAMEN

DAMEN SHIPYARDS GROUP

Avelingen-West 20
4202 MS Gorinchem
The Netherlands

P.O. Box 1
4200 AA Gorinchem
The Netherlands

phone +31 (0)183 63 99 22
fax +31 (0)183 63 21 89

info@damen.com
www.damen.com

© No part of the leaflet may be reproduced in any form, by print, photo print, microfilm, or any other means, without written permission from Damen Shipyards Group