



AZIMUTH STERN DRIVE TUG 2810

"VB SAHARA"

© Picture: Antonio Alcaraz Arbelo

GENERAL

Yard number	512383
Delivery date	February 2017
Basic functions	Towing, mooring and fire-fighting operations
Classification	I * HULL • MACH Tug Unrestricted Navigation AUT UMS IWS Fire Fighting Ship 1
Flag	St. Vincent
Owner	Boluda

DIMENSIONS

Length overall	28.67 m
Beam overall	10.43 m
Depth at sides	4.60 m
Draught aft	4.75 m
Displacement	553 t

TANK CAPACITIES

Fuel oil	72.6 m ³
Fresh water	16.4 m ³
Foam	6.6 m ³
Lubrication oil	9.2 m ³
Hydraulic oil	0.36 m ³
Dirty oil	3.1 m ³
Sewage	2.2 m ³
Sludge	3.1 m ³
Bilge water	5.2 m ³
Dispersant	4.7 m ³

PERFORMANCES

Bollard pull ahead	60.8 t
Bollard pull astern	56.0 t
Speed ahead	14.0 kn
Speed astern	13.8 kn

PROPULSION SYSTEM

Main engines	2x Caterpillar 3516C TA HD / C
Total power	3730 bkW (5000 bhp) at 1600 rpm
Azimuth thrusters	2x Rolls Royce US 205
Propeller diameter	2400 mm
Forced ventilation	55.000 m ³ /h

AUXILIARY EQUIPMENT

Generator sets	2x Caterpillar C4.4 TA, 230/400 V, 107 kVA, 50 Hz
Bilge pumps	2x Sterling AKHA 5101 each 20 m ³ /h
Fuel pumps	Sterling AKHA 4101 and AOHA 3101
Cooling system	Box cooling + anti-growth system
Fresh water pressure set	Sterling HBK 111 / AOHA 1202
Hydraulic system	Double main engine driven pumps
Fuel oil purifier	Westfalia OTC 2-02-137
Oil pollution control	Dispersant pumpset with 2 spraybooms
Fifi set	Diesel driven pump 2400 m ³ /h (FIFI 1)
Fifi monitor	2x 1200 m ³ /h, water/foam

DECK LAY-OUT

Anchors	2x 360 kg Pool (High Holding Power)
Anchor/towing winch	Hydraulically driven two speed winch with split drum and warping head, pull 35 ton at 9.2 m/min, slack rope speed up to 28 m/min, 150 ton brake
Capstan	Electrically driven, 5 ton at 15 m/min
Aft winch	Hydraulically driven two speed winch with spooling device, pull 35 ton at 9.2 m/min, reduced pull up to 27.6 m/min on second layer, 150 ton brake
Fendering	D-fender at sides, cylinder fender at transom corners, W-block bow fender and tyre fenders on fore ship

ACCOMMODATION

For 7 persons, insulated and finished with durable modern linings, acoustical ceiling in the wheelhouse, floating floors and air-conditioned. Captain's cabin, chief engineer's, one single + two double crew cabins, galley, mess/dayroom, dry store and sanitary facilities.

NAUTICAL AND COMMUNICATION EQUIPMENT

Searchlight	2x Xenon 450 W
Radar system	Furuno FAR 2117 with 19 inch screen
Compass	Magnetic Kottler
Autopilot	Simrad AP-70
GPS	Furuno GP-150
Echosounder	Furuno LS-6100
VHF	2x Sailor Compact 6222 (one with DSC)
VHF hand-held	2x Jotron Tron TR-20
Navtex	Furuno NX-700
ALS	Furuno FA-150
SSB	Furuno FS-1575
EPIRB	Jotron Tron-60S
Sart	Jotron Tron sart20
Anemometer	Observer, Windsonic OMS 115

DAMEN

AZIMUTH STERN DRIVE TUG 2810

"VB SAHARA"

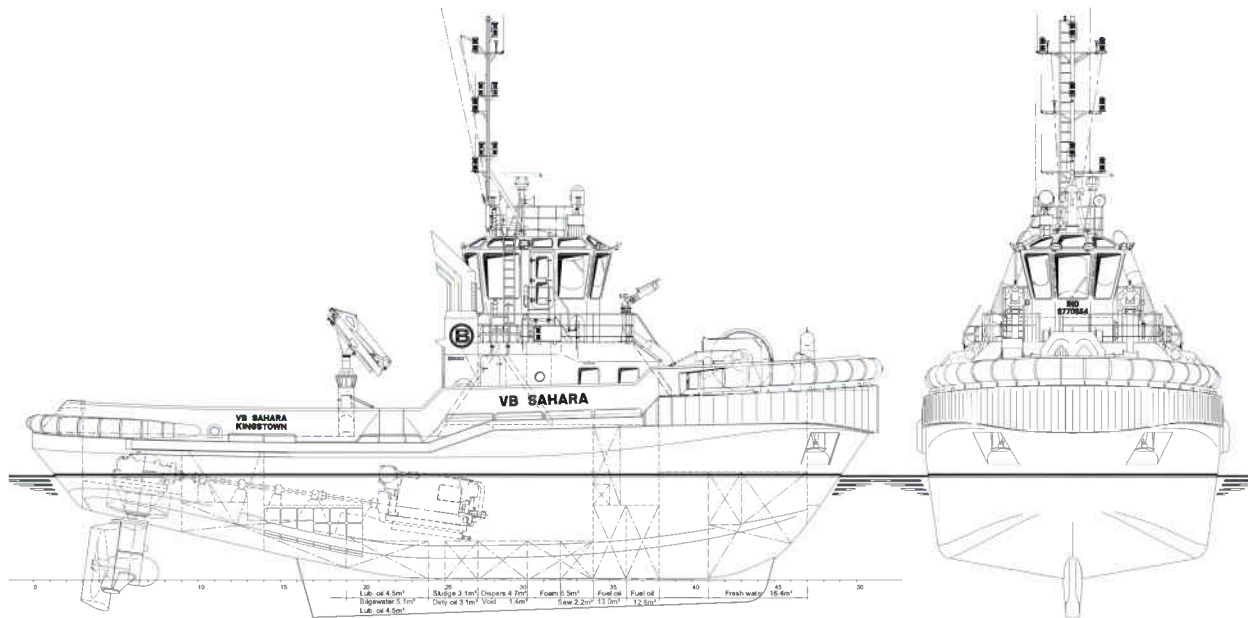

Main deck

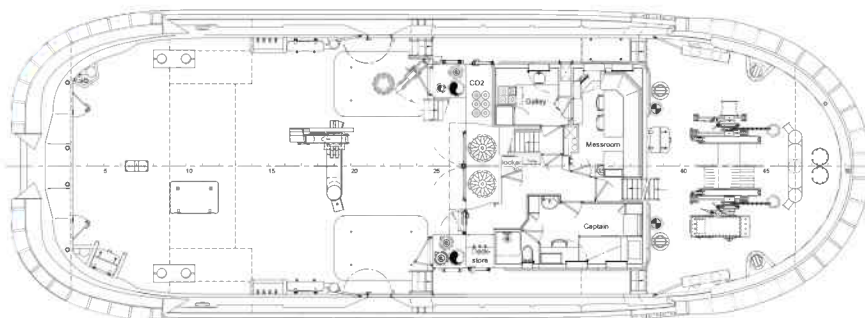

Top deck

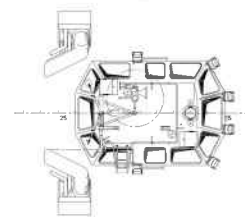

Below Main deck

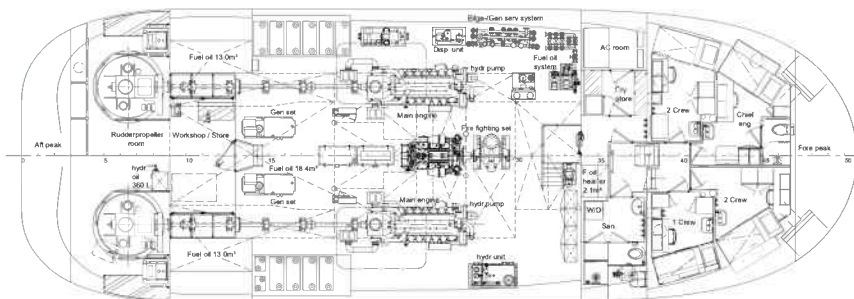

Bridge deck

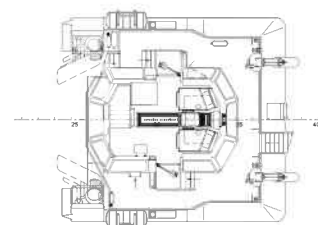

DAMEN

DAMEN SHIPYARDS GROUP

Avelingen-West 20
4202 MS Gorinchem
The Netherlands

P.O. Box 1
4200 AA Gorinchem
The Netherlands

phone +31 (0)183 63 99 22
fax +31 (0)183 63 21 89

info@damen.com
www.damen.com

© No part of the leaflet may be reproduced in any form, by print, photo print, microfilm, or any other means, without written permission from Damen Shipyards Group